



DEVELOPMENT VARIANCE PERMIT NO. DVP00279

STRATA CORPORATION VIS4811
Name of Owner(s) of Land (Permittee)

Civic Address: 1850 NORTHFIELD ROAD

1. This development variance permit is issued subject to compliance with all of the bylaws of the municipality applicable thereto, except as specifically varied by this permit.
2. This permit applies to and only to those lands within the municipality described below, and any and all building structures and other developments thereon:

Legal Description:

COMMON PROPERTY FOR STRATA PLAN VIS4811

LOTS 1-12, SECTION 18, RANGE 8, MOUNTAIN DISTRICT, STRATA PLAN VIS4811 TOGETHER WITH AN INTEREST IN THE COMMON PROPERTY

3. The City of Nanaimo "Development Parking Regulations Bylaw 2005 No. 7013" is hereby varied as follows:

Section 22.1 requires a specified number of parking spaces based on use. The variance is a reduction to a fixed 51 parking spaces.
4. The permittee, as a condition of the issuance of this permit, shall develop the land described herein strictly in accordance with the following terms and conditions and provisions and in accordance with any plans and specifications attached hereto which shall form a part thereof.

Schedule A Location Plan
Schedule B Site Plan

5. If the permittee does not substantially commence the construction permitted by this permit within two years of the date of this permit, this permit shall lapse.
6. This permit prevails over the provisions of the bylaw in the event of conflict.
7. This permit is not a building permit nor does it constitute approval of any signage. Separate applications must be made for a building permit and sign permit.

AUTHORIZING RESOLUTION PASSED BY COUNCIL
THE 16TH DAY OF MAY, 2016.



Corporate Officer

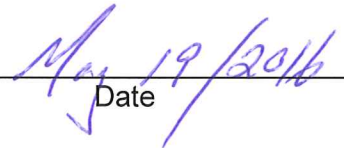

Date

Development Variance Permit DVP00279
1850 Northfield Road

Schedule A

Location Plan

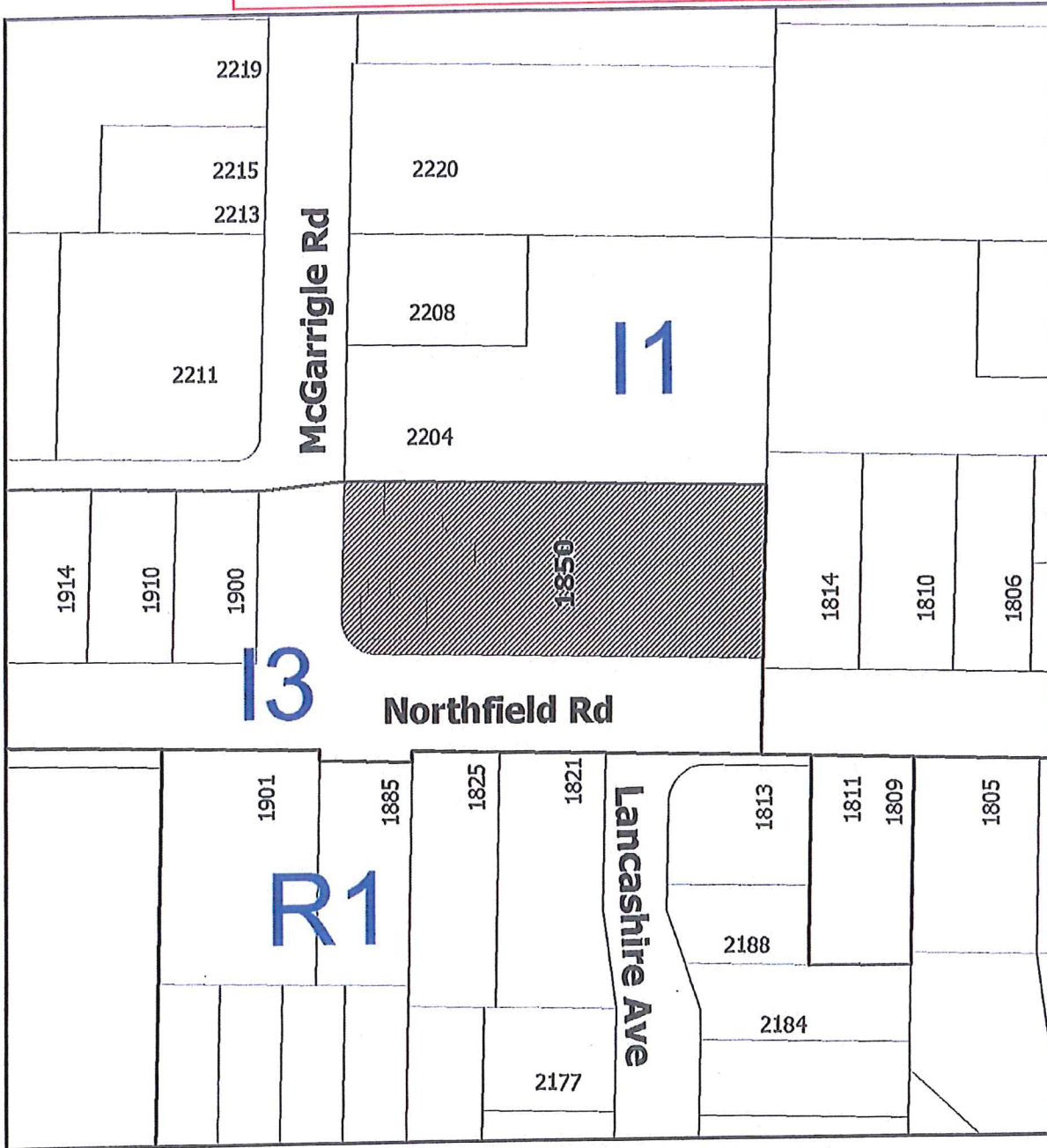

DEVELOPMENT VARIANCE PERMIT NO. DVP00279

LOCATION PLAN

Civic: 1850 Northfield Road

 Subject Property

Development Variance Permit DVP00279
 1850 Northfield Road

**Schedule B
 Site Plan**

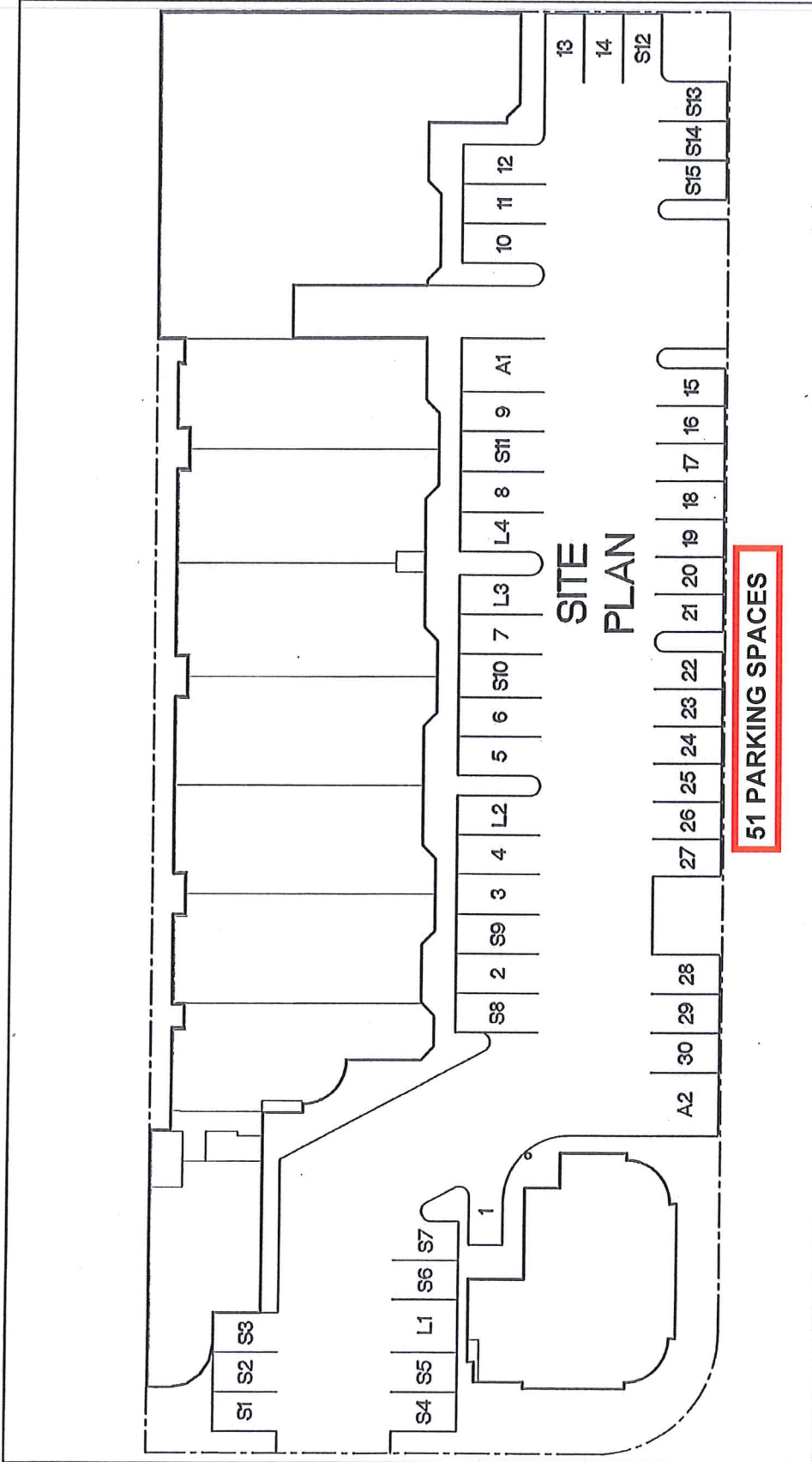

Drawing Title		Scale		Rev.	
SITE PLAN		1:250			
Project		Drawn		Drawing No.	
1850 NORTHFIELD ROAD AS-BUILTS, NANAIMO, BC		JL		A1	
		Date		10 NOV 15	



dup 279